

Welcome aboard!

Wolf Buddy & Darwin Buddy



Lower Deck.



L01

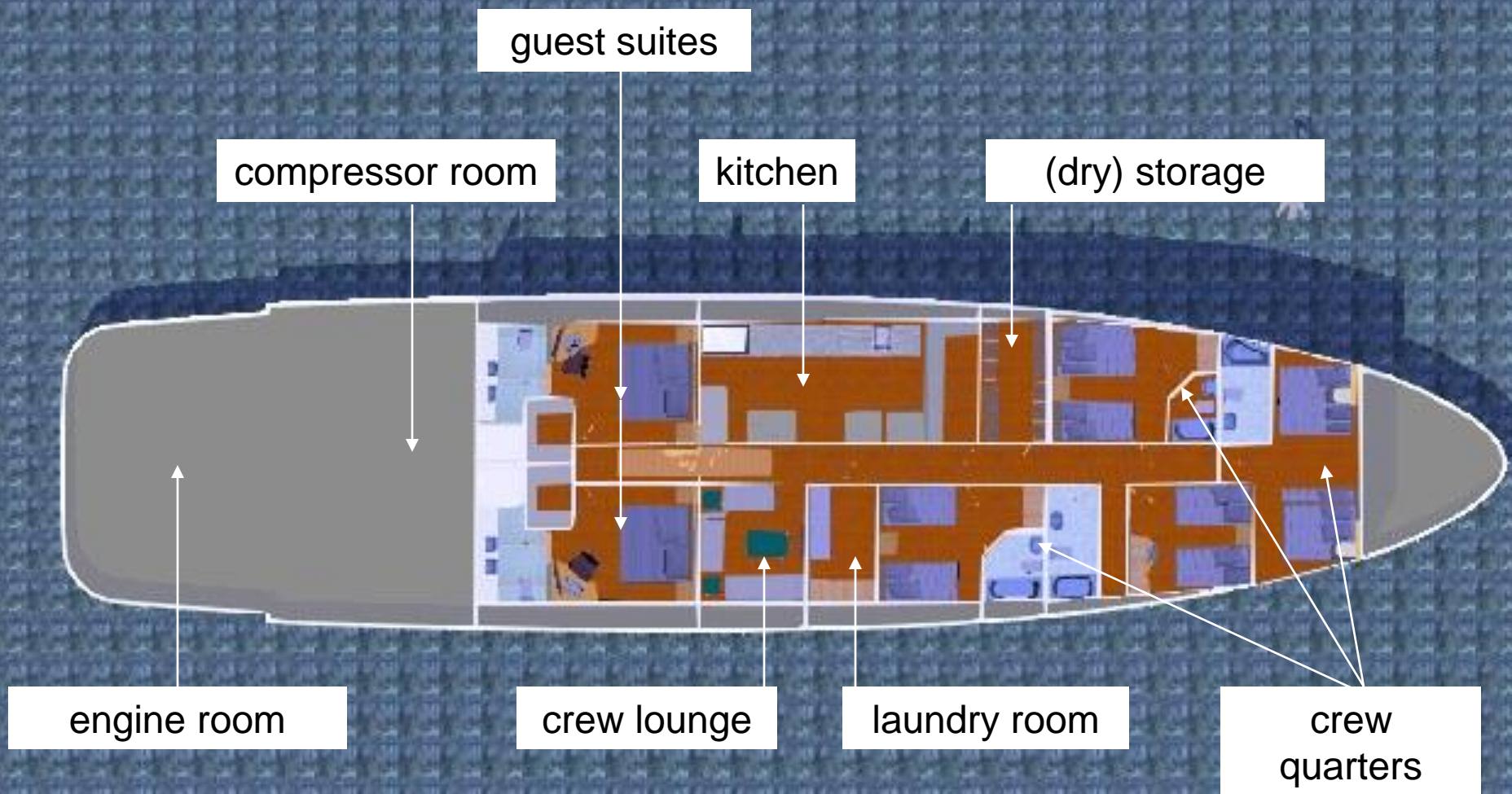

L02

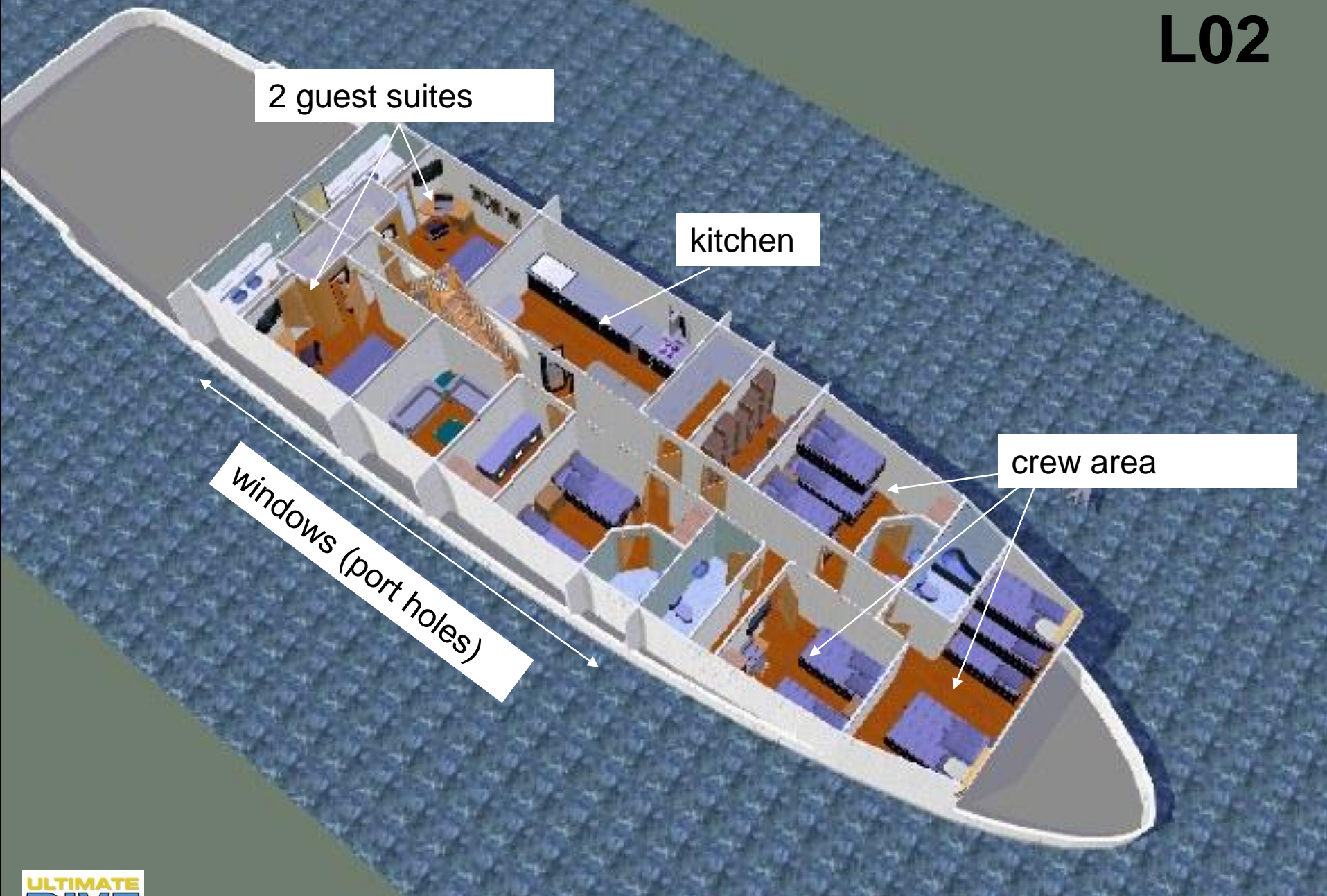

2 guest suites

kitchen

crew area

windows (port holes)

L03

bathroom with double sinks and spacious comfortable shower

port holes

double bed / 2 twins



Preliminary designs subject to further minor changes without notice.

turning in doors to walk-in closet

flat screens, incl. DVD and laptop connection



guest suites



L06



Main Deck.



M07

dining / breakfast area
with buffet and egg/grill station

1 guest suite with panorama
view, double bed only, sitting
area in front

dive decks, incl.
warm-up area
(details not yet displayed)

inside / outside bar

2 guest suites with walk-in closets

guest lounge area with media &
entertainment center

dining / breakfast area

buffet with egg/grill station

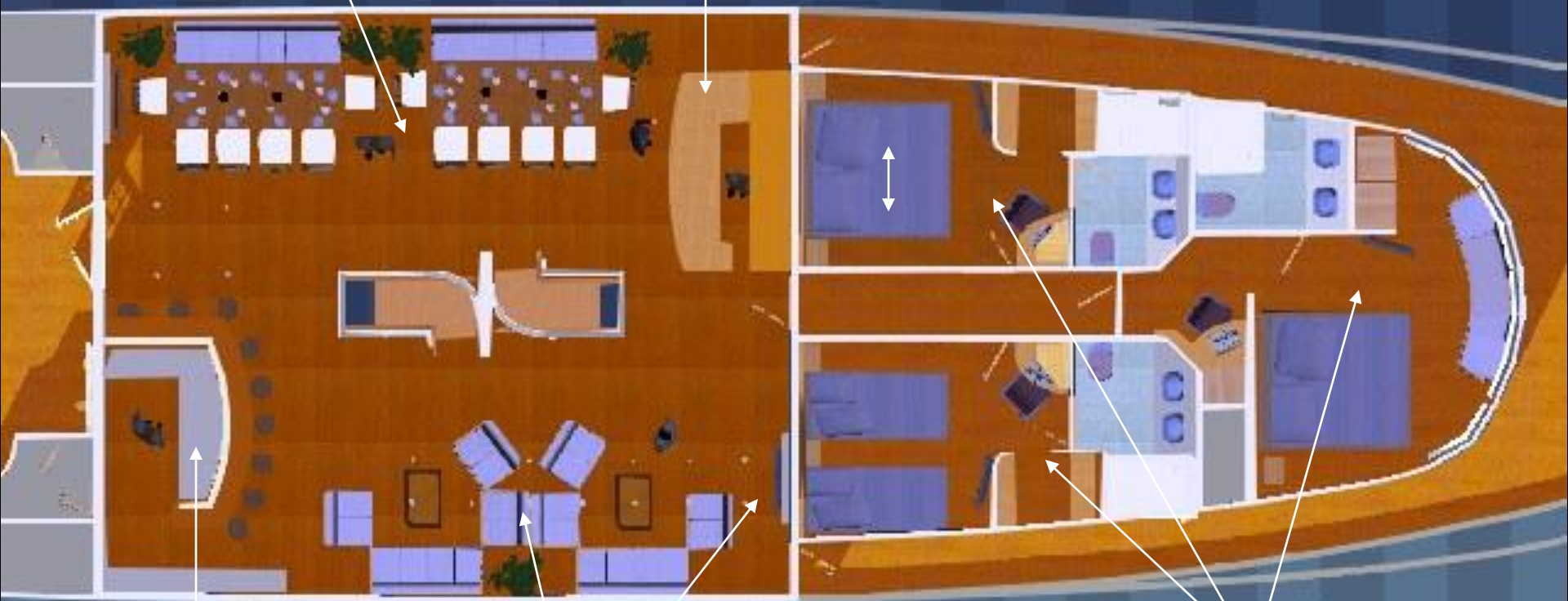

inside / outside bar

guest lounge area with media & entertainment center

3 guest suites

M09

panorama window
(not yet displayed)

bar

guest lounge area

M10

walk-in closet

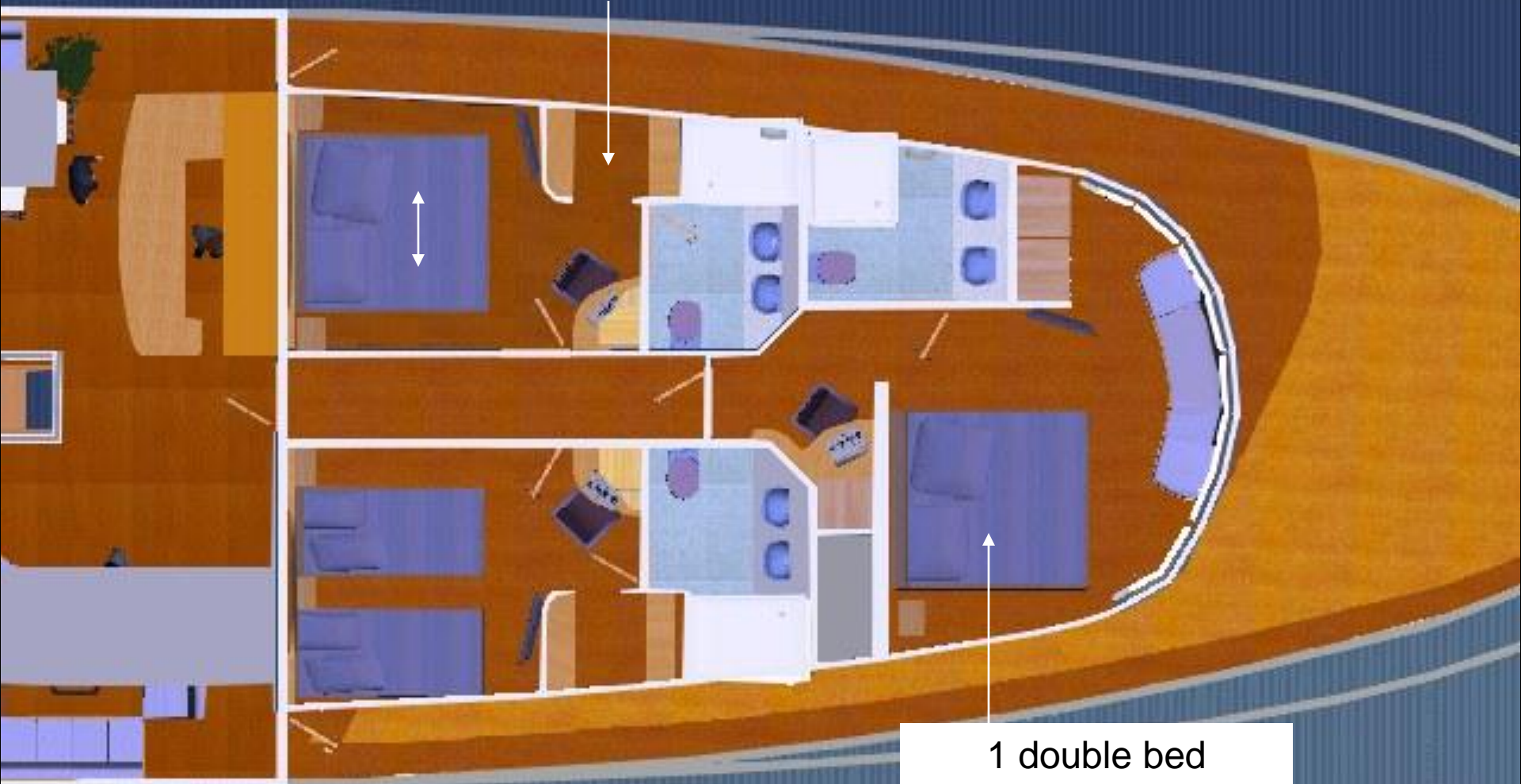

1 double bed

public lavatories / showers

buffet with egg/grill station

storage

dive decks

Inside / outside bar

guest lounge area with media & entertainment center



Preliminary designs subject to further minor changes without notice.

M12



M13



M14



M15



Preliminary designs subject to further minor changes without notice.

M16

inside / outside bar

to the dive decks

M17

panorama windows
(not yet displayed)

to the front

to guest quarters

Preliminary designs subject to further minor changes without notice.



buffet with egg/grill station



Upper Deck.



U19

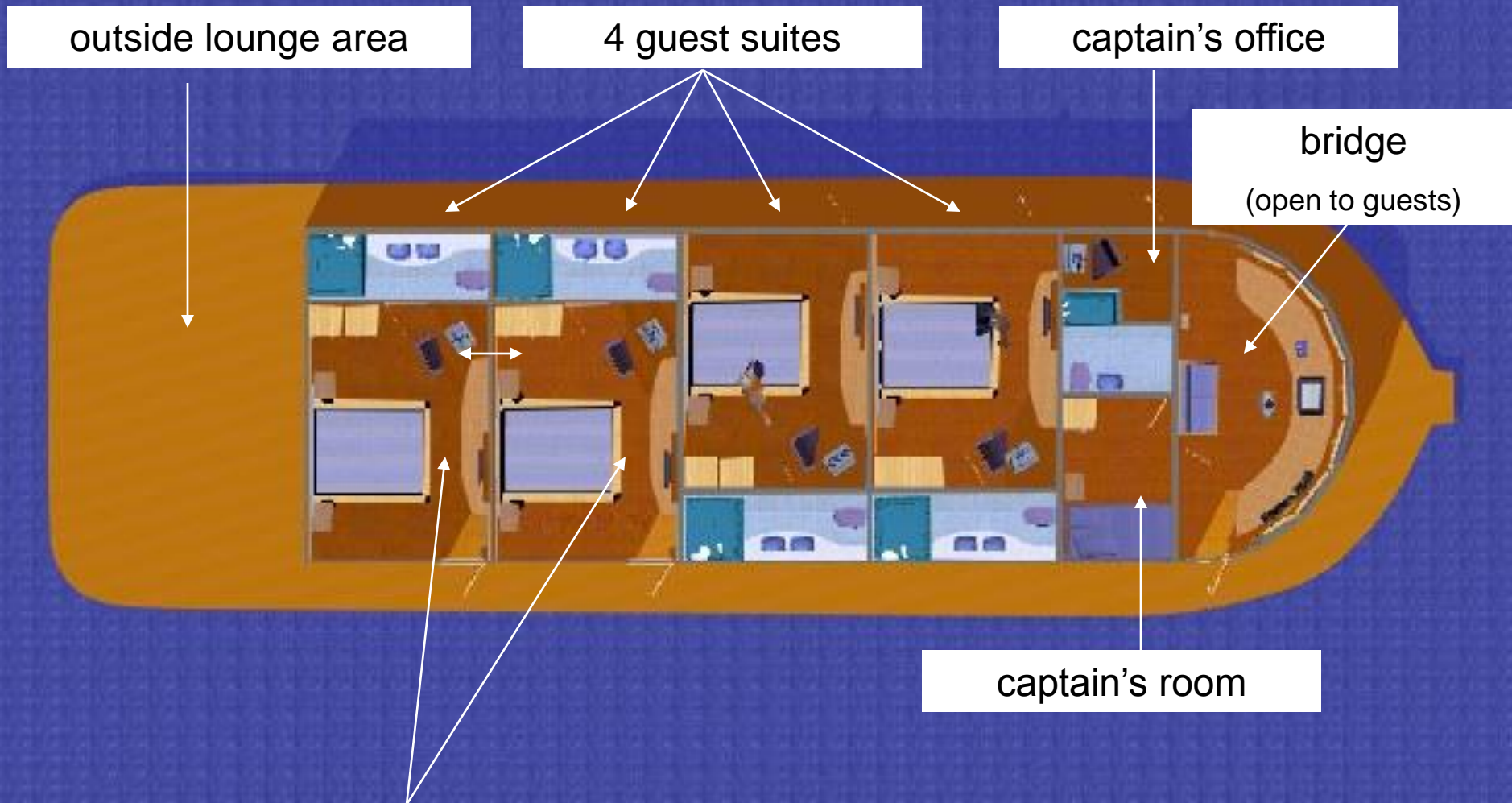

The set up of these rooms is to be mirrored. Connecting doors allow usage as one luxurious suite.

4 guest suites



connecting door / potential suite

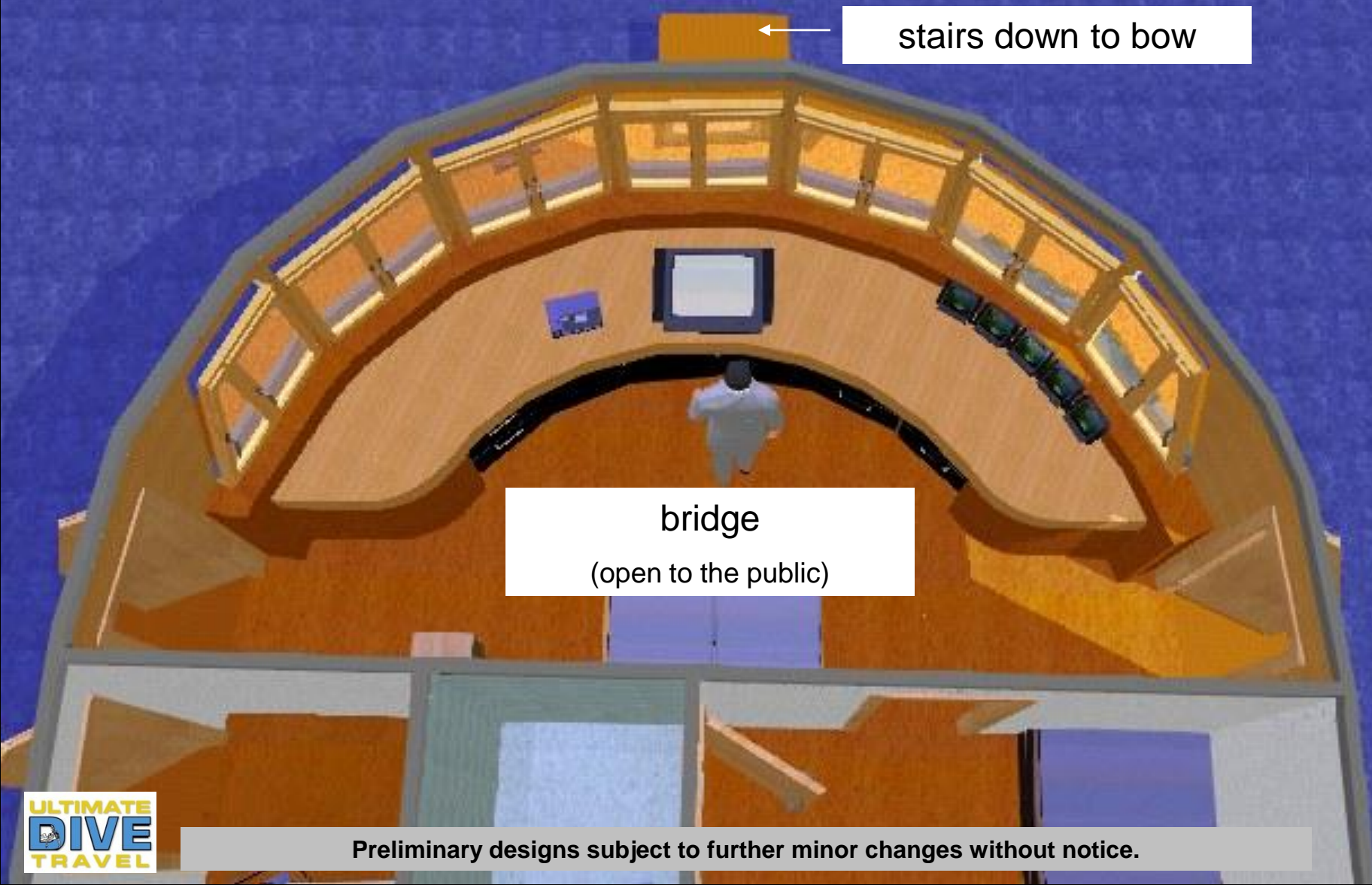

← stairs down to bow

bridge
(open to the public)

U22



U23



Buddy Dive Liveaboards



- Enjoy the difference!

More space.

More comfort to enjoy the enchantment.

The cabins with their pleasant contemporary interior design allow a maximum of comfort and space.

Local decision maker.

Our partner's home base is Galapagos.

In case that a quick decision needs to be made, it is possible by our local partner. He knows the islands, he knows people & possibilities and can arrange a solution on the spot, if necessary.

Time buffer.

No worries, if your plane comes in delayed! Hop-on on day 2 also possible.

The cruises start on San Cristobal Island on Saturdays. As they head for North Seymour / Mosquera on Sunday, passengers, who missed the cruise start or lost their luggage, need to complete their equipment etc, have a second chance to fly to Baltra Island and embark the yacht on day 2.

Jet propulsion.

Reduced safety risk for man and marine life.

Buddy Wolf and Buddy Darwin are the first yachts with a jet propulsion. This means that they are not only faster (and reduce travel times), but also make environmentally friendlier cruises possible. We achieve more security for divers and creatures around the vessel by not threatening their well being with fast turning propellers that might cause severe injuries.



Custom-made.

Fulfilling diver's needs and requirements ... and a little more.

Buddy Wolf & Buddy Darwin are the first true custom-made dive vessels cruising the Galapagos.

So everything is catering divers and their requirements. We even have a specially designed dive and activity platform with a heated area. All divers will be received back on board with a warm towel and a cup of delicious Ecuadorian hot chocolate.

Plenty of additional ideas.

Hospitality without limits ... we are continuously creating more amenities for our guests.

You may remain curious! There are much more extras to come... We'll keep you posted!

Buddy Dive Resort Bonaire.

Making the trip complete.

For all those who want it all: a dive safari **and** land based excursions.

To maximize the underwater time combine a Resort vacation **and** the dive safari. Unlimited dive packages are available at [Buddy Dive Resort](#), Bonaire.

Nitrox included.

No extra charges for those who choose to dive Nitrox.

